

VIKING<sup>®</sup>  
**Universal Seal**  
PUMPS

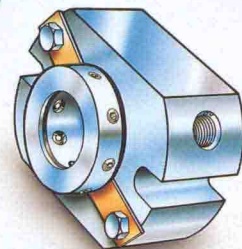

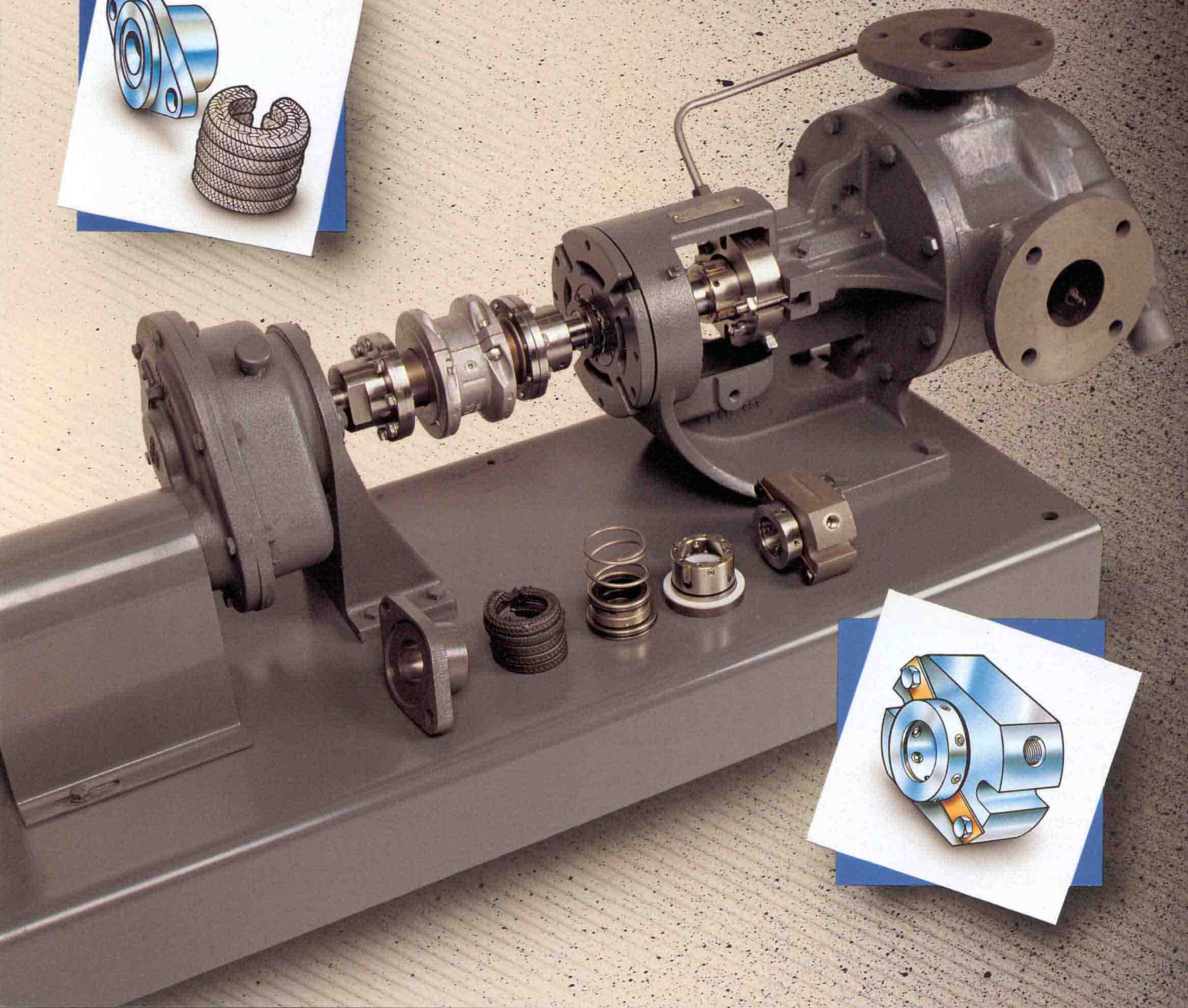

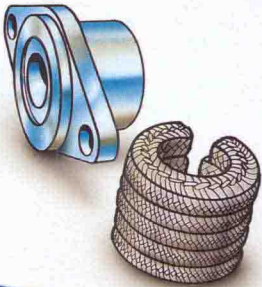
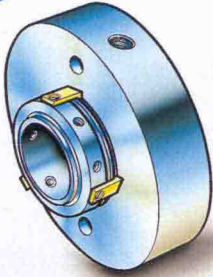
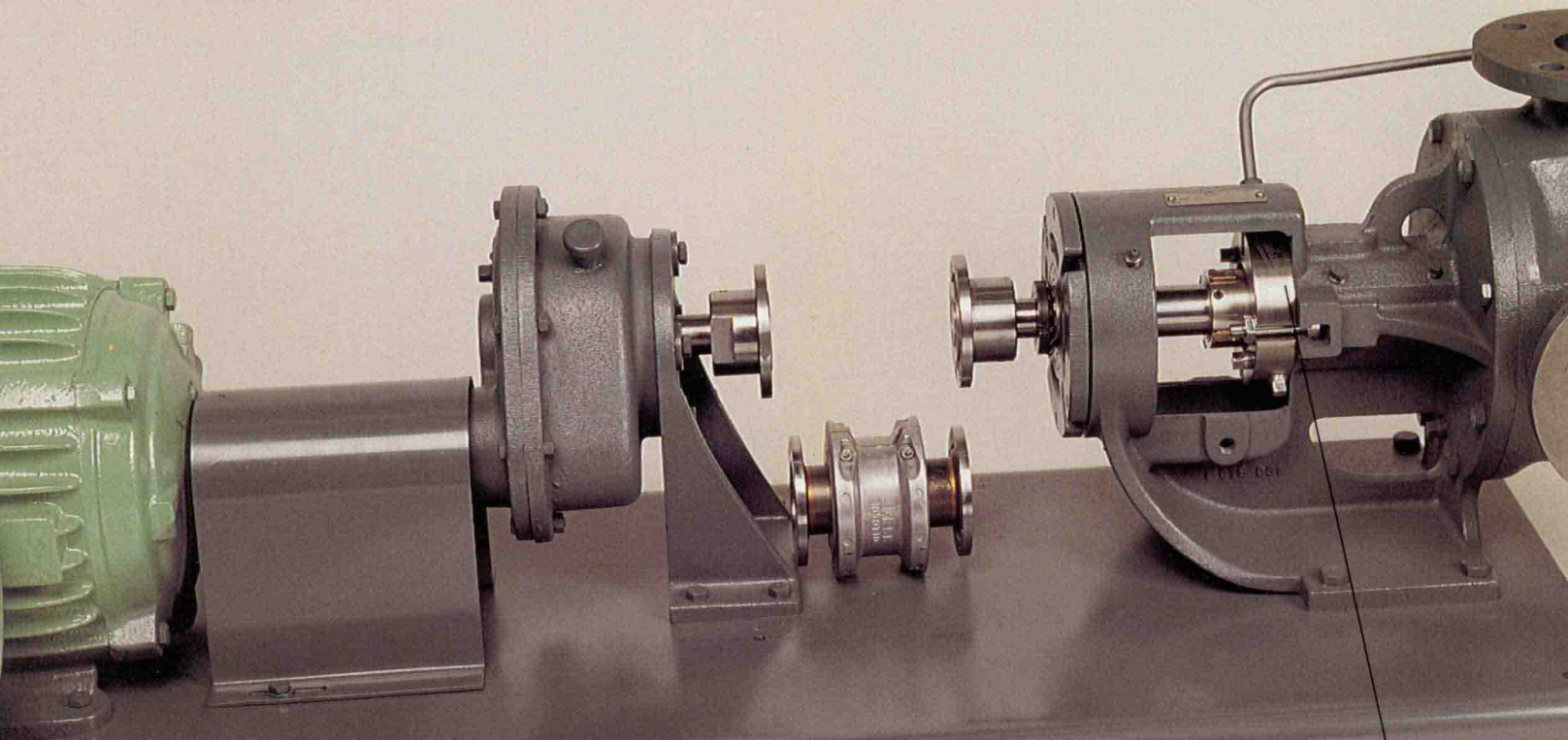

Packing/Seal  
Gland

Braided  
Packing

Component  
Mechanical  
Seal

Cartridge  
Mechanical  
Seal

Single or  
Double  
Cartridge  
Mechanical  
Seal

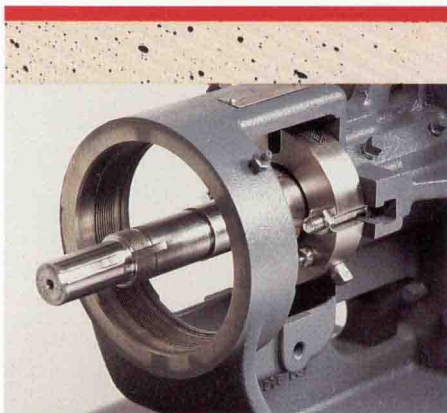

An enlarged bearing housing is standard on Viking's Universal Seal Pump. This permits easy adaptability for a wide variety of sealing options. Seal maintenance is quick and easy without disassembly of the pump head.

# Easy maintenance and sealing options give you flexibility in your pumping applications.



**V**iking's design team has developed our Universal Seal Pump to allow you easy seal maintenance. An enlarged one-piece bearing housing eliminates disassembly of the pump head. This feature, combined with a spacer coupling, creates a seal that can be replaced and maintained in the field with easy removal through the rear of the pump.

Looking for a heavy-duty pump that offers sealing option flexibility? The Viking Universal Seal Pump offers the most flexibility in the industry.

**Check out these features. All standard. All Viking!**

As with every Viking product, innovation, quality, and service have been engineered into the Universal Seal Pump series. Standard features include:

■ **Revolvable Pump Casings.**

All Viking Universal Seal Pumps are equipped with casings that can be turned to eight positions (except the "LQ", "LL" and "QS" sizes). These sizes can be put in place in all positions except for a port in the 6 o'clock position. Relief valve must point to suction port in all applications.

■ **Overpressure Relief Valve.**

This allows for the bypassing of liquids and prevents excessive pressures in the discharge line.

■ **Enlarged Bearing Housing.**

Permits easy axial positioning of rotor and shaft on Universal Seal Pump. Cartridge seals are easily accessible.

**Choose Viking**

As with all Viking heavy-duty pumps, our Universal Seal Pumps operate equally well in either direction. The Viking "gear-within-a-gear" principle provides low-shear, cushioned pumping for a wide range of applications without foaming or churning. Viking Universal Seal Pumps are available mounted or unmounted. Some sizes are available with a jacketed head plate.

**SPEEDS:**

to 1800 RPM

**NOMINAL FLOWS:**

to 500 GPM

**PRESSURES:**

to 200 PSI

**TEMPERATURES:**

-120° F. - + 800° F.

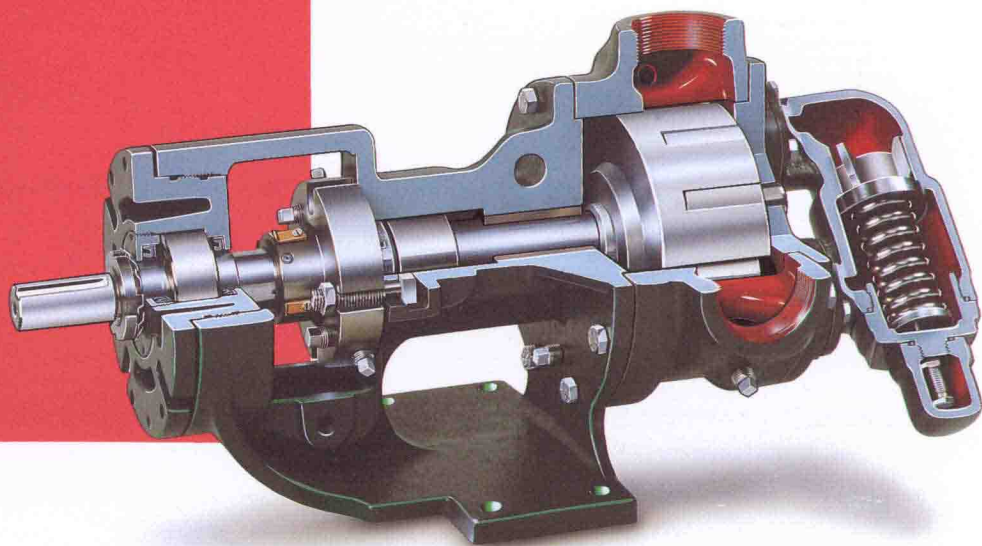



**SPECIFICATIONS—UNMOUNTED PUMPS SERIES 124A AND 4124A (CAST IRON CONSTRUCTION)  
126A AND 4126A (DUCTILE IRON EXTERNAL CONSTRUCTION)  
123A AND 4123A (STEEL EXTERNAL CONSTRUCTION)  
127A AND 4127A (STAINLESS STEEL CONSTRUCTION)**

① Model Numbers		Port Size	② Nominal Pump Rating		Maximum Hydrostatic Pressure	Steel-Fitted Construction Recommended Above This Viscosity	③ Maximum Recommended Discharge Pressure When Handling 100 SSU Liquid At Rated Speeds	④ Maximum Recommended Temperature For Cataloged Pump °F.		Approximate Shipping Weight With Valve (Less Power)
Packed	⑤ Mech. Seal	Inches	GPM	RPM	PSIG	SSU	PSIG	Packed	Mech. Seal	Pounds
H124A	H4124A	1½	15	1800	400	25,000	200	300	225	38
H126A	H4126A	1½	15	1800						38
H123A	H4123A	⑥ 1½	15	1800						43
H127A	H4127A	⑥ 1½	10	1200	400	7,500	200	300	225	48
HL124A	HL4124A	1½	30	1800						40
HL126A	HL4126A	1½	30	1800						40
HL123A	HL4123A	⑥ 1½	30	1800	400	25,000	200	300	225	45
HL127A	HL4127A	⑥ 1½	20	1200						50
K124A	K4124A	2	75	780						105
K126A	K4126A	2	75	780	400	25,000	200	300	225	105
K123A	K4123A	⑥ 2	75	780						120
K127A	K4127A	⑥ 2	45	520						125
KK124A	KK4124A	2	100	780	400	25,000	200	300	225	110
KK126A	KK4126A	2	100	780						110
KK123A	KK4123A	⑥ 2	100	780						125
KK127A	KK4127A	⑥ 2	65	520	400	25,000	200	300	225	130
L124A	L4124A	2	135	640						155
L126A	L4126A	2	135	640						155
LQ124A	LQ4124A	⑥ 2½	135	640	400	25,000	200	300	225	175
LQ126A	LQ4126A	⑥ 2½	135	640						175
LQ123A	LQ4123A	⑥ 2½	135	640						185
LQ127A	LQ4127A	⑥ 2½	90	420	400	2,500	200	300	225	205
LL124A	LL4124A	⑥ 3	140	520						185
LL126A	LL4126A	⑥ 3	140	520						185
LL123A	LL4123A	⑥ 3	140	520	400	75,000	150	300	225	195
LL127A	LL4127A	⑥ 3	110	420						240
LS124A	LS4124A	⑥ 3	200	640						190
LS126A	LS4126A	⑥ 3	200	640	400	75,000	150	300	225	190
LS123A	LS4123A	⑥ 3	200	640						200
LS127A	LS4127A	⑥ 3	160	520						220
Q124A	Q4124A	⑥ 4	300	520	400	7,500	150	300	225	440
Q126A	Q4126A	⑥ 4	300	520						440
Q123A	Q4123A	⑥ 4	300	520						450
Q127A	Q4127A	⑥ 4	200	350	400	75,000	150	300	225	460
QS124A	QS4124A	⑦ 6	500	520						540
QS126A	QS4126A	⑦ 6	500	520						540
QS123A	QS4123A	⑦ 6	500	520	400	—	100	275	275	550
QS127A	QS4127A	⑦ 6	320	350						560

- ① External material construction of pumps is as follows: 124A and 4124A—Cast Iron; 126A and 4126A—Ductile Iron, 123A and 4123A—Steel, and 127A and 4127A—Stainless Steel.
- ② Nominal rating based on handling thin liquids.
- ③ For maximum recommended discharge pressures when handling other viscosities and/or other speeds, see performance curves in catalog sections 141, 151, 161, and 210. Performance curves also show preferred constructions. If suction pressure exceeds 50 PSIG, consult factory.
- ④ Cartridge-type Viton® mechanical seals can be used from -20°F. to +400°F. depending

on seal manufacturer. With special construction, higher temperatures can be handled with these series pumps.

- ⑤ For cartridge-type mechanical seal pumps on applications with viscosities above 35,000 SSU, provide details for recommendation.
- ⑥ Ports are suitable for use with 125# ANSI cast iron or 150# ANSI steel companion flanges or flanged fittings. All others tapped for standard pipe.
- ⑦ Ports are opposite flanged suitable for 125# ANSI cast iron or 150# ANSI steel companion flanges or flanged fittings.

Viton® is a registered trademark of the DuPont Company.

**For more information, write or phone us.**

**VIKING  
PUMP**

INNOVATION. QUALITY. SERVICE.

VIKING PUMP, INC.  
A Unit of IDEX Corporation  
Cedar Falls, Iowa 50613 U.S.A.  
Telephone: (319) 266-1741  
FAX: (319) 273-8157  
We're known as **ROTO-KING® PUMPS** in Canada

**IDEX**  
CORPORATION

Printed in U.S.A. Form No. 401-B